



higher education & training

Department:
Higher Education and Training
REPUBLIC OF SOUTH AFRICA

Ingwe TVET College



Enquiries: N Futshane

Tel: 039 940 2142

Ext: 122

ADVERT

BID DESCRIPTION	BID NO	COMPULSORY BRIEFING SESSION	CLOSING DATE	ENQUIRIES
CONSTRUCTION OF STORM WATER DRAINAGE CHANNEL FOR NGQUNGQUSHE CAMPUS	INGWE/020/2022	DATE 02/02/2022 TIME 10H30am VENUE NGQUNGQUSHE CAMPUS LUSIKISIKI	DATE: 08 February 2022	Technical: Mr O Hanise Tel: 039 940 2142 SCM: Ms N Futshane Tel: 039 940 2142

Kindly furnish me with a written quotation for the provision of services as detailed in the enclosed specification. The quotation must be submitted on the letterhead of your business or have your business stamp. Quotation maybe hand delivered before **12H00pm at Ingwe TVET College, Mount Frere Administration Offices at the security gate** or email to nfutshane@ingwecollege.edu.za

THE FOLLOWING MANDATORY DOCUMENTS MUST BE SUBMITTED WITH THE QUOTATION AND FAILURE TO SUBMIT WILL LEAD TO THE BIDS BEING DECLARED NON-RESPONSIVE:

- Price(s) quoted must be valid for at least thirty (30) days from date of your offer.
- Price(s) quoted must be firm and must be inclusive of VAT.
- Firm Delivery Period must be indicated.
- A valid Tax Clearance certificate and SARS TAX Compliance status with PIN.
- 2021 updated Full CSD report (Central Supplier Database)
- Certified BBBEE certificate
- Company Municipal statement of Account that is not older than 3 (three) month or Lease Agreement or Affidavit from SAPS stating that the bidder is not obliged to pay municipal rates or a letter from a ward councilor
- Joint Ventures to attach: JV Agreement, Consolidated BBBEE certificate and letter of Signatory
- The following forms should be attached with the bid/RFQ submitted:
 - **Completed SBD 4,8,9**
- **Certified proof of CIDB grading 1CE or Higher**

BIDDERS SHOULD TAKE NOTE OF THE FOLLOWING BID CONDITIONS:

- Ingwe TVET College Supply Chain Management Policy will apply;
- 80/20 preferential procurement point system will be applied.
- Ingwe TVET College does not bind itself to accept the lowest bid or any other bid and reserves the right to accept the whole or part of the bid;
- Bids which are late, incomplete, unsigned will not be accepted.
- No quotations will be considered from persons in the service of the state.
- Failure to comply with these conditions may invalidate your offer.
- Late bids will not be considered.

Central Office
Badibanise Village
Mount Frere
Tel: 039 940 2142

Mount Frere Campus
Cancele Road
Mount Frere
Tel: 039 940 2142 ext.200

Ngqungqushe Campus
Magwa Road
Lusikisiki
Tel: 039 940 2142 ext.300

Siteto Campus
Mhlanga Village
Bizana
Tel: 039 940 2142 ext.400

Maluti Campus
Mli Road
Maluti
Tel: 039 940 2142 ext.500

Mt Fletcher Campus
Hospital Area
Mount Fletcher
Tel: 039 940 2142 ext.600

www.ingwecollege.edu.za

NB: TERMS OF REFERENCE ATTACHED

Evaluation Criteria for this procurement will be as follows:

- Stage 1 – Functionality
- Stage 2 – Price and Preferential Points

Only Bidders who score 60% or more on stage 1 would be proceed to evaluation stage 2.

EVALUATION CRITERIA

The 80/ 20 preferential procurement point system will be applied as the project is estimated to be more than **R30 000.00**

Price - 80 point
B-BEE status level of Contribution- 20 points

BBBEE Points Breakdown:

LEVEL	POINTS AWARDED
1	20
2	18
3	16
4	12
5	8
6	6
7	4
8	2
Non – compliant	0

DELIVERY ADDRESS:

INGWE TVET COLLEGE
ADMINISTRATION OFFICES
BADIBANISE LOCATION A/A
MOUNT FRERE
5090

Yours faithfully

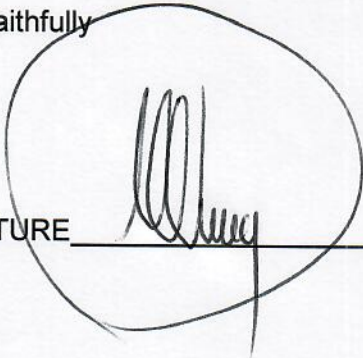

SIGNATURE _____

Published on: 31 January 2022

Central Office
Badibanise Village
Mount Frere
Tel: 039 940 2142

Mount Frere Campus
Cancele Road
Mount Frere
Tel: 039 940 2142 ext.200

Ngqungqushu Campus
Magwa Road
Lusikisiki
Tel: 039 940 2142 ext.300

Siteto Campus
Mhlanga Village
Bizana
Tel: 039 940 2142 ext.400

Maluti Campus
Mli Road
Maluti
Tel: 039 940 2142 ext.500

Mt Fletcher Campus
Hospital Area
Mount Fletcher
Tel: 039 940 2142 ext.600

www.ingwecollege.edu.za

FUNCTIONALITY	REQUIRED EVIDENCE	WEIGHT	MAX VALUE (1- 5)
1.Experience			
(a) Number of clients (contactable references) or list of similar projects that the bidder has successfully undertaken in the past five years to the value of R 500 000.00 or above per project.			
Bidder has successfully completed 3 or more projects	Proof of professional experience: Signed reference letters in relation to the required services must be attached. Practical certificate and appointment letters will not be considered. Only project completed within the past 5 years will be considered. NB: 0 points will be claimed where submitted clients/ references cannot be contacted.	40	5
Bidder has successfully completed 2 or more projects			4
Bidder has successfully completed 1 projects			2
Bidder did not any reference letters			0
2. Expertise			
(a) Project Manager/ Site Agent with relevant Academic Qualifications and detailed CV			
More than 04 years' experience and qualifications	Bidders must submit detailed CVs with certified copies of the required professional qualifications. If the required certified copies of professional qualifications are not attached no points will be allocated. Copy of a certified copy will not be considered	20	5
03 to 04 years' experience and qualifications			3
02 to 04 years' experience and qualifications			2
Less than 2 years' experience and qualifications			0
TOTAL		90	450

BILL NO	100			UNIT	QUANTITY	RATE	AMOUNT
PAYMENT REF	ITEM NO	DESCRIPTION					
1200 A	100,01	<u>GENERAL</u>		Sum	1		
8.2.1	100,02	Scheduled fixed-charge and value-related items:		Sum	1		
		.01 Fixed preliminary and general charges					
		.02 Value-related preliminary and general charges		Sum	1		
8.2.2	100,03	Scheduled time-related items:					
		.01 Time-related preliminary and general charges					
TOTAL CARRIED FORWARD TO NEXT PAGE							

Contract

Hamid

PSDB 832	14225	Excavate open drains in all materials				
SITE CLEARANCE SUBTOTAL CARRIED TO TOTAL						R

BILL NO	300					
PAYMENT REF	ITEM NO	DESCRIPTION	UNIT	QUANTITY	RATE	AMOUNT
1200 DK	300,01	GABIONS AND PITCHING				
821	14601	Surface preparation for bedding of gabions:	m ²	411		
822	14602	Gabions:				
		1 Gabion mattresses of galvanized wire, up to 0,3 m deep:				
		2 2 m x 1 m x 300 mm Maccaferri	m ³	90		

Handwritten signature

824	14604	reno mattress or similar approved Geotextile: .01 Filter fabric, Kaymat U24 or Bidim A4 or approved equivalent	m ²	411		
EARTHWORKS (PIPE TRENCHES) SUBTOTAL CARRIED TO TOTAL						

Handwritten signature

BILL NO	500					
PAYMENT REF	ITEM NO	DESCRIPTION	UNIT	QUANTITY	RATE	AMOUNT
1200 LE	500,01	STORMWATER DRAINAGE	No.	1,00		
8.2.14	500,02	Cast-in-situ concrete, formwork, and reinforcing steel .01 Outlet structure for trapezoidal channel as per drawing				
STORMWATER DRAINAGE SUBTOTAL CARRIED TO TOTAL						

Contract
Part C2: Pricing Data
Contract No.

Handwritten signature

BILL NO	500					
PAYMENT REF	ITEM NO	DESCRIPTION	UNIT	QUANTITY	RATE	AMOUNT
1200 MK	22800	KERBING AND CHANNELLING				
827	22809	Trimming of excavations for lined open drains in:				
		1 Soft material	m ²	40,00		
		2 Intermediate material	m ²	100,00		
		3 Hard material	m ²	60,00		

Handwritten signature

STORMWATER DRAINAGE SUBTOTAL CARRIED TO TOTAL									R

Contract
Part C2: Pricing Data C2.2 Contract No. Bill of Quantities

Haww

LUSIKISIKI INGWE TVET COLLEGE CIVIL BOQ

R

Bill No	SANS	SECTION	TOTAL (EXCL. VAT)
<u>100</u>	<u>1200A</u>	GENERAL	
<u>300</u>	<u>1200D</u>	EARTHWORKS	
<u>400</u>	<u>1200DB</u>	EARTHWORKS (PIPE TRENCHES)	
<u>500</u>	<u>1200DK</u>	GABIONS AND PITCHING	
<u>900</u>	<u>1200LE</u>	STORMWATER DRAINAGE	
<u>1400</u>	<u>1200MK</u>	KERB AND CHANNELING	
Sub-Total : (Excluding VAT)			R
VALUE ADDED TAX (VAT)			R

Handwritten signature

TOTAL INCL VAT

R

Heun

LEGEND:

- EXISTING STORMWATER
- PROPOSED STORMWATER CHANNEL
- PROPOSED OUTLET STRUCTURE

CESA

GREEN BUILDING

INGWE TVET COLLEGE LUSIKISIKI

LUSIKISIKI STORMWATER DESIGN

STORMWATER LAYOUT & LONG SECTION

Drawing Title: STORMWATER LAYOUT & LONG SECTION
 Drawing Date: 11/20/2018
 Drawing Scale: AS SHOWN
 Prepared By: [Name]
 Checked By: [Name]
 Approved By: [Name]

TENDER

Client: higher education & training
 PROJECT OFFICE: 11/20/2018
 PROJECT ADDRESS: 11/20/2018
 PROJECT CONTACT: 11/20/2018
 PROJECT PHONE: 11/20/2018

DELTA

11/20/2018
 11/20/2018
 11/20/2018
 11/20/2018

REVISIONS

No.	Description of changes	By	Date
1	11/20/2018	11/20/2018	11/20/2018

INGWE TVET COLLEGE LUSIKISIKI

LUSIKISIKI STORMWATER DESIGN

STORMWATER LAYOUT & LONG SECTION

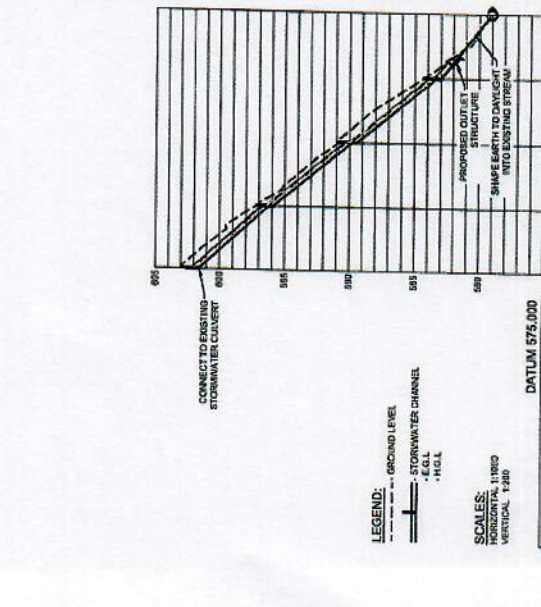
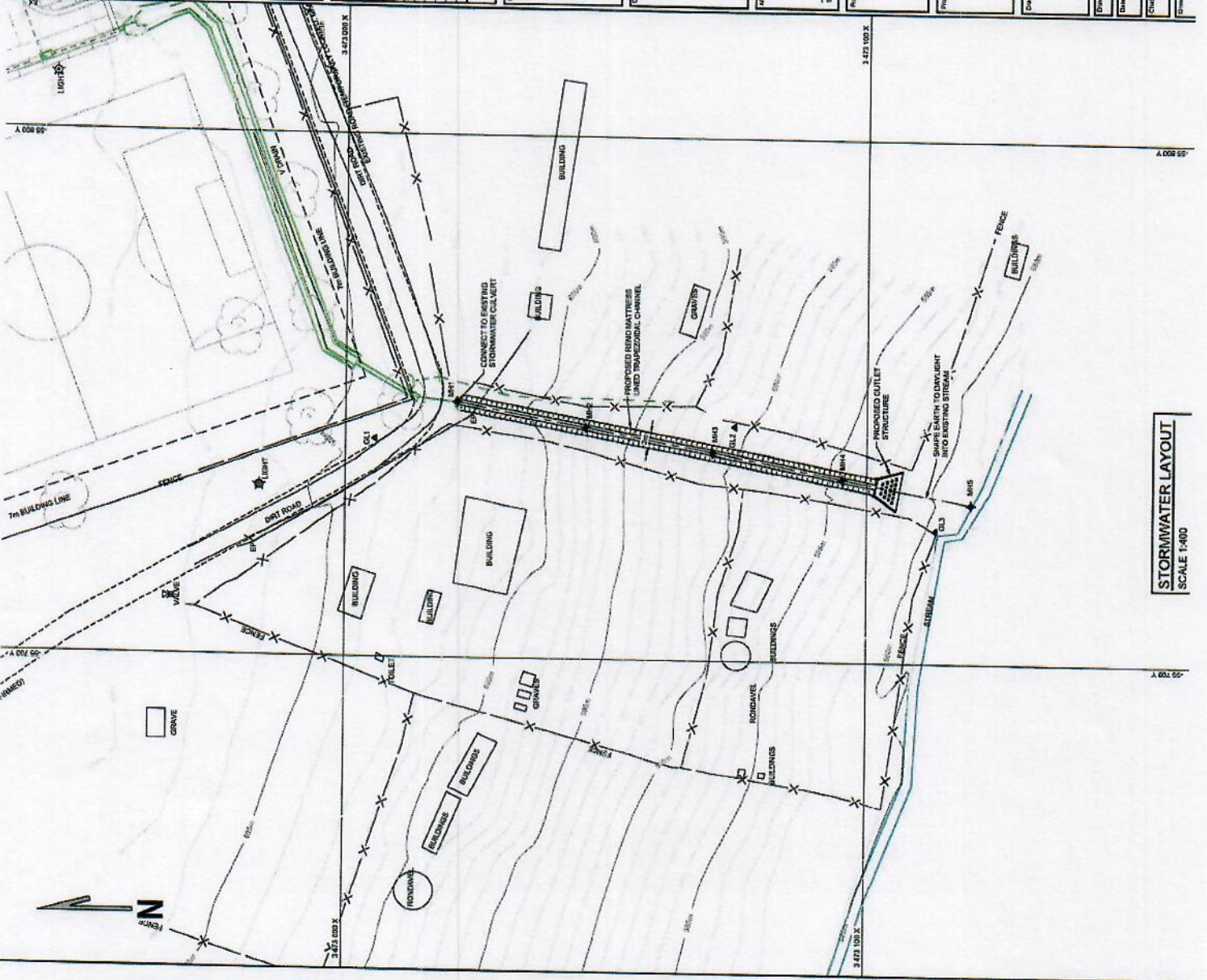

RENO MATTRESS LINED TRAPEZOIDAL CHANNEL LONG SECTION FROM 0.000 TO 100.316

REFERENCE	DISTANCE (m)	GROUND LEVEL	PIPE INVERT LEVEL	DEPTH TO INVERT	SLOPE/LENGTH
M1	0.000	1.000	0.800	0.200	0.11
M2	25.000	0.950	0.750	0.200	0.11
M3	50.000	0.900	0.700	0.200	0.11
M4	75.000	0.850	0.650	0.200	0.11
M5	100.316	0.800	0.600	0.200	0.11

RENO MATTRESS LINED TRAPEZOIDAL CHANNEL SETTING OUT DATA Lo 28 (WGS 84 DATUM)

POINT	Y-COORD	X-COORD	INVERT LEVEL
M1	55 742 253	3 472 021 267	0.81
M2	55 742 253	3 472 040 025	0.85
M3	55 742 253	3 472 058 783	0.89
M4	55 742 253	3 472 077 541	0.93
M5	55 742 253	3 472 096 299	0.97

BENCHMARKS SETTING OUT DATA Lo 31 (WGS 84 DATUM)

NAME	Y-COORD	X-COORD	ELEVATION	DESCRIPTION
BL1	55 742 253	3 472 096 299	10.00	10mm PEG
BL2	55 742 253	3 472 096 299	10.00	10mm PEG
BL3	55 742 253	3 472 096 299	10.00	10mm PEG

STORMWATER LAYOUT SCALE 1:400

Handwritten signature: *Hamm*

